

WIDTH ADJUSTABLE JOIST HANGER TYPE 3 (2-PIECE)

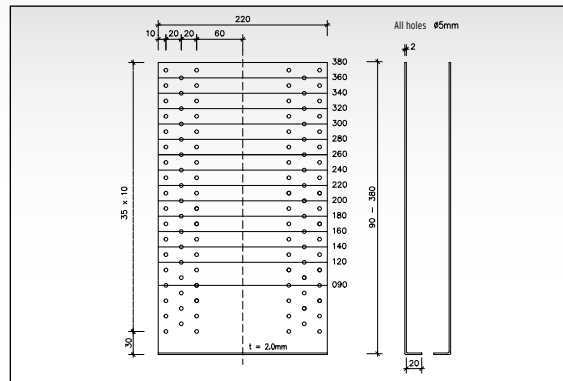
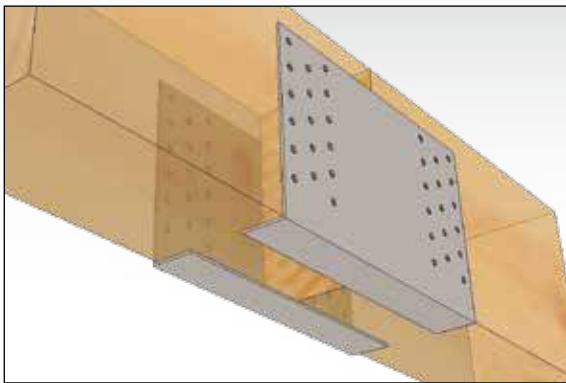
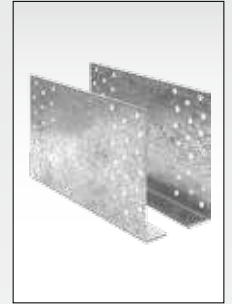

ETA application submitted

Art. No.	Dimensions [mm]					n ¹ Ø 5	Total number of holes	EAN	Weight kg	Pallet	PU Pair
	H	x	W	x	D						
209	90	x	220	x	2.0	2x9	36	177051	0.780	480	20
212	120	x	220	x	2.0	2x15	60	177068	0.995	480	20
214	140	x	220	x	2.0	2x17	68	177006	1.100	480	20
216	160	x	220	x	2.0	2x20	80	177075	1.225	480	20
218	180	x	220	x	2.0	2x23	92	177013	1.350	360	15
220	200	x	220	x	2.0	2x26	108	177020	1.460	360	15
222	220	x	220	x	2.0	2x29	118	177037	1.590	360	15
224	240	x	220	x	2.0	2x32	128	177082	1.770	240	10
226	260	x	220	x	2.0	2x35	140	177044	1.840	240	10
228	280	x	220	x	2.0	2x38	144	177099	1.981	240	10
230	300	x	220	x	2.0	2x41	162	177105	2.120	240	10
232	320	x	220	x	2.0	2x44	176	177112	2.260	240	10
234	340	x	220	x	2.0	2x47	188	177129	2.400	240	10
236	360	x	220	x	2.0	2x50	200	177136	2.540	240	10
238	380	x	220	x	2.0	2x53	212	177143	2.680	240	10

n¹ = number of holes, timber

GH width-adjustable joist hangers, Type 3 are used for simple formation of a joint of hinged ridge purlins in the point of zero moment.

Both timber members are cut straight.

In addition to material costs, high production costs are also saved, as there is no need to make notches or to drill holes.

Due to the large distance of the nails from the joint ($120/2 = 60$ mm),

the nail spacing is also kept parallel with the fibre (loaded edge). Tailor-made versions can be made to your particular wishes.

For fixing with GH connector nails (page 89), GH screws (page 90). Made of hot-dip galvanised steel sheet $t = 2$ mm.

NOTE: WIDTH-ADJUSTABLE JOIST HANGER TYPE 2 (2-PIECE) NOW ON PAGE 76

