

JOIST HANGER TYPE I 05 / 2.5 COMBINATION, EXTRA STRONG

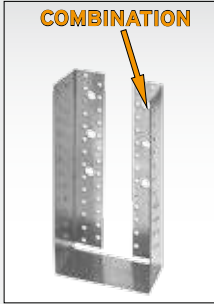

Art. No.	Dimensions [mm]					nH <sup>1</sup>	nN <sup>2</sup>	nH <sup>1</sup>	0769	EAN	Weight	Pallet	PU
	W	x	H	x	D	Ø 5	Ø 5	Ø 13					
40501IKO	100	x	240	x	2.5	46	30	6	ETA-08/0264	4019346	kg	480	20
40502IKO	100	x	280	x	2.5	54	34	6	ETA-08/0264	017883	0.995	480	20
40503IKO	100	x	300	x	2.5	58	36	6	ETA-08/0264	017890	1.133	480	20
40504IKO	100	x	320	x	2.5	62	38	6	ETA-08/0264	017906	1.201	480	20
40505IKO	120	x	240	x	2.5	46	30	6	ETA-08/0264	017913	1.270	480	20
40506IKO	120	x	280	x	2.5	54	34	6	ETA-08/0264	101506	1.030	480	20
40507IKO	120	x	300	x	2.5	58	36	6	ETA-08/0264	017920	1.167	480	20
40508IKO	120	x	320	x	2.5	62	38	6	ETA-08/0264	017937	1.236	480	20
40513IKO	140	x	200	x	2.5	38	22	6	ETA-08/0264	017944	1.304	480	20
40509IKO	140	x	240	x	2.5	46	30	6	ETA-08/0264	018170	0.927	480	20
40549IKO	140	x	260	x	2.5	50	32	6	ETA-08/0264	100738	1.064	480	20
40510IKO	140	x	280	x	2.5	54	34	6	ETA-08/0264	018187	1.133	480	20
40511IKO	140	x	300	x	2.5	58	36	6	ETA-08/0264	017951	1.201	480	20
40512IKO	140	x	320	x	2.5	62	38	6	ETA-08/0264	017968	1.270	480	20
40516IKO	160	x	160	x	2.5	30	18	4	ETA-08/0264	017975	1.338	480	20
40517IKO	160	x	200	x	2.5	38	22	6	ETA-08/0264	100745	0.824	360	15
40518IKO	160	x	240	x	2.5	46	30	6	ETA-08/0264	100752	0.961	360	15
40561IKO	160	x	260	x	2.5	50	32	6	ETA-08/0264	017982	1.098	360	15
40519IKO	160	x	280	x	2.5	54	34	6	ETA-08/0264	018194	1.168	360	15
40532IKO	160	x	300	x	2.5	58	36	6	ETA-08/0264	017999	1.236	360	15
40520IKO	160	x	320	x	2.5	62	38	6	ETA-08/0264	018200	1.305	360	15
40542IKO	180	x	180	x	2.5	34	20	4	ETA-08/0264	018002	1.373	360	15
40521IKO	180	x	200	x	2.5	38	22	6	ETA-08/0264	102220	0.925	240	10
40522IKO	180	x	220	x	2.5	42	26	6	ETA-08/0264	018019	0.995	240	10
40523IKO	180	x	240	x	2.5	46	30	6	ETA-08/0264	100714	1.064	240	10
40524IKO	180	x	280	x	2.5	54	34	6	ETA-08/0264	018026	1.133	240	10
40555IKO	180	x	320	x	2.5	62	38	6	ETA-08/0264	018033	1.270	240	10
40527IKO	200	x	200	x	2.5	38	22	6	ETA-08/0264	020319	1.408	240	10
40525IKO	200	x	240	x	2.5	46	30	6	ETA-08/0264	017685	1.030	240	10
40529IKO	220	x	260	x	2.5	50	32	6	ETA-08/0264	100769	1.167	240	10
40533IKO	240	x	280	x	2.5	54	34	6	ETA-08/0264	018040	1.202	240	10
40533IKO	240	x	280	x	2.5	54	34	6	ETA-08/0264	018057	1.441	240	10

● Standard sizes | nH<sup>1</sup> = number of holes in the flanges facing the main member nN<sup>2</sup> = number of holes in the flanges facing the secondary member  
 Further dimensions on request.



Type I 05 / 2.5

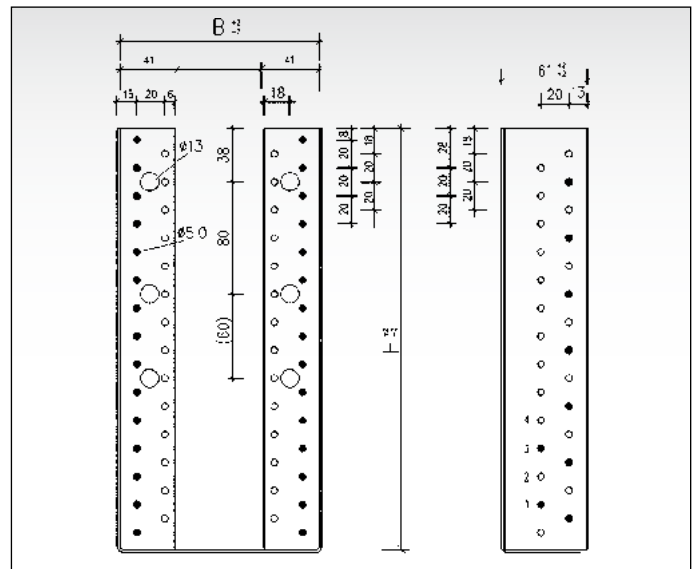

• for partial nailing  
 European approval. Made of hot-dip galvanised steel sheet.  
 For fixing with GH connector nails (page 89), GH screws (page 90).

