

JOIST HANGER TYPE I 05 / 2.0



Art. No.	Dimensions [mm]					nH ¹	nN ²	0769	EAN	Weight	Pallet	PU
	W	x	H	x	D							
4050121	100	x	240	x	2.0	46	30	ETA-08/0264	4019346	kg	480	20
4050221	100	x	280	x	2.0	54	34	ETA-08/0264	503386	0.860	480	20
4050321	100	x	300	x	2.0	58	36	ETA-08/0264	503393	0.970	480	20
4050421	100	x	320	x	2.0	62	38	ETA-08/0264	501306	1.030	480	20
4050521	120	x	240	x	2.0	46	30	ETA-08/0264	501313	1.090	480	20
4050621	120	x	280	x	2.0	54	34	ETA-08/0264	501320	0.890	480	20
4050721	120	x	300	x	2.0	58	36	ETA-08/0264	501337	1.000	480	20
4050821	120	x	320	x	2.0	62	38	ETA-08/0264	501344	1.060	480	20
4051321	140	x	200	x	2.0	38	22	ETA-08/0264	501351	1.120	480	20
4050921	140	x	240	x	2.0	46	30	ETA-08/0264	501573	0.810	480	20
4054921	140	x	260	x	2.0	50	32	ETA-08/0264	501375	0.910	480	20
4051021	140	x	280	x	2.0	54	34	ETA-08/0264	501580	0.980	480	20
4051121	140	x	300	x	2.0	58	36	ETA-08/0264	501382	1.030	480	20
4051221	140	x	320	x	2.0	62	38	ETA-08/0264	501399	1.090	480	20
4051621	160	x	160	x	2.0	30	18	ETA-08/0264	502006	1.150	480	15
4051721	160	x	200	x	2.0	38	22	ETA-08/0264	502013	0.710	360	15
4051821	160	x	240	x	2.0	46	30	ETA-08/0264	502020	0.830	360	15
4056121	160	x	260	x	2.0	50	32	ETA-08/0264	502037	0.940	360	15
4051921	160	x	280	x	2.0	54	34	ETA-08/0264	501597	1.010	360	15
4053221	160	x	300	x	2.0	58	36	ETA-08/0264	502044	1.060	360	15
4052021	160	x	320	x	2.0	62	38	ETA-08/0264	501603	1.130	360	15
4054221	180	x	180	x	2.0	34	20	ETA-08/0264	502051	1.180	360	15
4052121	180	x	200	x	2.0	38	22	ETA-08/0264	502198	0.810	240	10
4052221	180	x	220	x	2.0	42	26	ETA-08/0264	502068	0.860	240	10
4052321	180	x	240	x	2.0	46	30	ETA-08/0264	502075	0.910	240	10
4052421	180	x	280	x	2.0	54	34	ETA-08/0264	502082	0.970	240	10
4055521	180	x	320	x	2.0	62	38	ETA-08/0264	502099	1.090	240	10
4052721	200	x	200	x	2.0	38	22	ETA-08/0264	020302	1.220	240	10
4052521	200	x	240	x	2.0	46	30	ETA-08/0264	502709	0.890	240	10
4052921	220	x	260	x	2.0	50	32	ETA-08/0264	502716	1.000	240	10
4053321	240	x	280	x	2.0	54	34	ETA-08/0264	502730	1.090	240	10
									502747	1.180	240	10



● **Standard sizes** | nH¹ = number of holes in the flanges facing the main member nN² = number of holes in the flanges facing the secondary member
 Further dimensions on request.

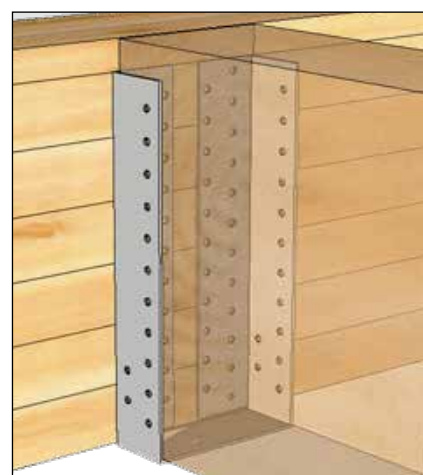
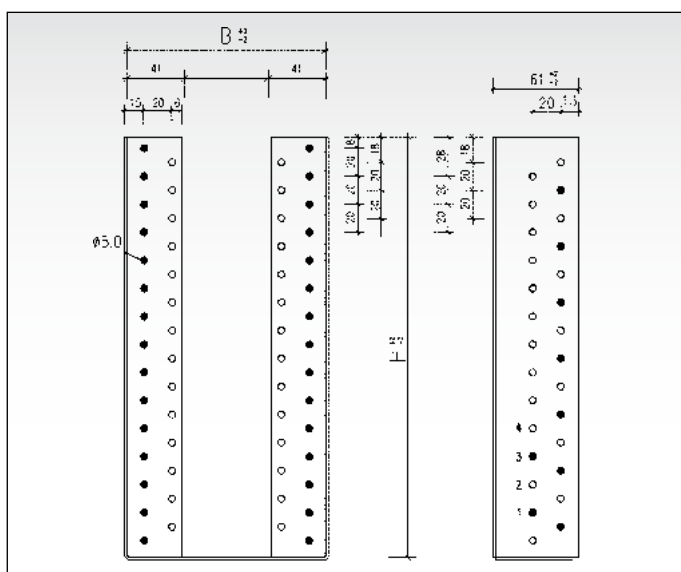

Type I 05 / 2.0

● **for partial nailing**

European approval. Made of hot-dip galvanised steel sheet.
 For fixing with GH connector nails (page 89), GH screws (page 90).

