

INTEGRAL CONNECTOR, 2-ROWS TYPE M WITH FIXED MOUNTING PLATE

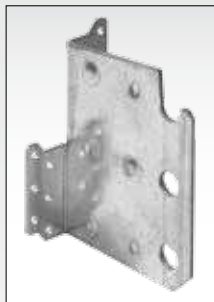

Art. No.	Type	Dimensions [mm]					nH	nN	0769	EAN	Weight	Pallet	PU
		H	x	L	x	D							
30200	M 0	84	x	98	x	3.0	8	2	ETA-10/0009	4019346	kg	1200	25
30201	M I	124	x	98	x	3.0	12	3	ETA-10/0009	105078	0.295	900	25
30202	M II	164	x	98	x	3.0	16	4	ETA-10/0009	105085	0.395	1000	25
30203	M III	204	x	98	x	3.0	20	5	ETA-10/0009	105092	0.495	600	25
30204	M IV	244	x	98	x	3.0	24	6	ETA-10/0009	105108	0.595	600	25

nH = number of holes facing the main member | nN = number of holes facing the secondary member

INTEGRAL CONNECTOR, 4-ROWS TYPE M WITH FIXED MOUNTING PLATE

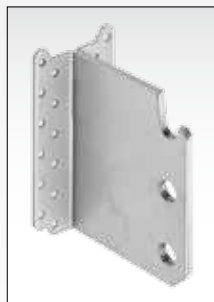

Art. No.	Type	Dimensions [mm]					nH	nN	0769	EAN	Weight	Pallet	PU
		H	x	L	x	D							
302004	M 0 -4	84	x	98	x	6.0	16	2	ETA-10/0009	479704	0.390	1000	25
302014	M I -4	124	x	98	x	6.0	24	3	ETA-10/0009	479711	0.590	1000	25
302024	M II -4	164	x	98	x	6.0	32	4	ETA-10/0009	479728	0.790	1000	25
302034	M III -4	204	x	98	x	6.0	40	5	ETA-10/0009	479735	0.990	600	25
302044	M IV -4	244	x	98	x	6.0	48	6	ETA-10/0009	479742	1.190	600	25

nH = number of holes facing the main member | nN = number of holes facing the secondary member

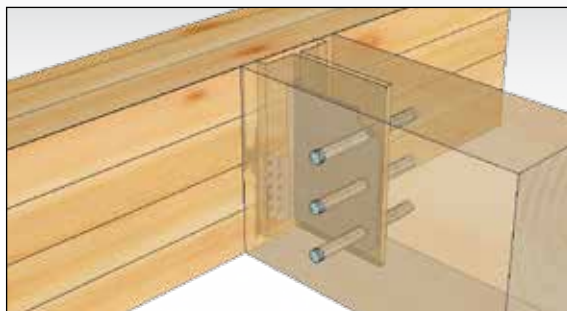

Dowels from page 91.

INTEGRAL CONNECTOR, 2-ROWS TYPE M INCLINED JOINT OF 30° - 90°

Art. No.	Type	Dimensions [mm]					nH	nN	0769	EAN	Weight	PU
		H	x	L	x	D						
30200L	Type 0 -L	84	x	98	x	3.0	8	2	595053	0.195	1	
30200R	Type 0 -R	84	x	98	x	3.0	8	2	105306	0.195	1	
30201L	Type I -L	124	x	98	x	3.0	12	3	595060	0.295	1	
30201R	Type I -R	124	x	98	x	3.0	12	3	105320	0.295	1	
30202L	Type II -L	164	x	98	x	3.0	16	4	595077	0.395	1	
30202R	Type II -R	164	x	98	x	3.0	16	4	105344	0.395	1	
30203L	Type III -L	204	x	98	x	3.0	20	5	595084	0.495	1	
30203R	Type III -R	204	x	98	x	3.0	20	5	105368	0.495	1	
30204L	Type IV -L	244	x	98	x	3.0	24	6	595091	0.595	1	
30204R	Type IV -R	244	x	98	x	3.0	24	6	105382	0.595	1	

Setup costs per degree value and stop direction

30210	Setup costs	105405	0	1
-------	-------------	--------	---	---

nH = number of holes facing the main member | nN = number of holes facing the secondary member

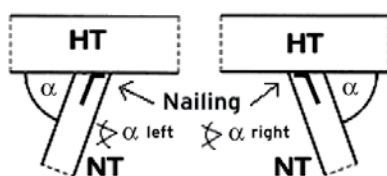

Inclined joints
left/right from
30° - 90° available

