

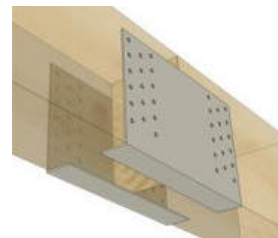

**GH - Width-adjustable joist hanger Type 3 (2-piece)**

EN 1995-1-1



**Properties**

Steel grade S 250GD  
 Surface Z 275g/m<sup>2</sup> both sides, approx. 20 μm

**Fasteners**

**in timber**

GH connector nails (threaded nails) 4.0 x 40 / 50 / 60 / 75 / 100 mm  
 GH screw 5.0 x 40 / 50 / 60 / 70 mm

**Nail pattern**

The nailing must always be complete (full nailing).

**Basis of calculation**

req b	=	required cross-section width
req h	=	required cross-section height
F <sub>V,Rd</sub>	=	Design value of the load-carrying capacity of the width-adjustable joist hanger
F <sub>V,Rk</sub>	=	Characteristic load-carrying capacity of the width-adjustable joist hanger
LDC	=	Load duration class

**Remarks:**

Timber strength class 350 kg/m<sup>3</sup> char. density.  
 Verification of tension perpendicular to the grain must be provided separately according to EN 1995-1-1 8.1.4.  
 If the required cross-section width and height are satisfied, the requirements in accordance with EN 1995-1-1 8.3.1 for edge distances and spacings as well as allowable overlap lengths are fulfilled.  
 The fastener load-carrying ability was not reduced to EN 1995-1-1 8.3 (8).

All calculations and values are exclusively for GH products and their fasteners.  
 The load-bearing capacities were determined on the basis of ETA 13/0523. It is not possible to transfer the values to third party makes.

**Disclaimer:**

Despite careful calculations and checking, no liability is accepted for the technical data.  
 Subject to change without notice.

For technical drawing, see website [www.holzverbinder.de](http://www.holzverbinder.de)



„Innovationen im Holzbau“

**Design values of the load-carrying capacity (resistance)  $F_{V,Rd}$  and characteristic load-carrying capacity (resistance)  $F_{V,Rk}$  in kN**  
**Timber-to-timber connections with arrangement of a connector pair**

Width-adjustable joist hanger	Number of nails per pair	req h in mm	d x L	req b in mm	LDC					
					permanent	long-term	medium-term	short-term	instantaneous	charact.
					$F_{V,Rd}$	$F_{V,Rd}$	$F_{V,Rd}$	$F_{V,Rd}$	$F_{V,Rd}$	$F_{V,Rk}$
220x90x2.0	2 x 18	110	4x40	54	3,18	3,71	4,24	4,76	5,82	6,88
			4x50	64	3,75	4,37	4,99	5,62	6,87	8,12
			4x60	74	4,00	4,67	5,33	6,00	7,33	8,67
220x120x2.0	2 x 28	140	4x40	54	5,88	6,86	7,85	8,83	10,8	12,7
			4x50	64	6,94	8,10	9,25	10,4	12,7	15,0
			4x60	74	7,41	8,64	9,88	11,1	13,6	16,1
220x140x2.0	2 x 34	160	4x40	54	7,96	9,28	10,6	11,9	14,6	17,2
			4x50	64	9,38	10,9	12,5	14,1	17,2	20,3
			4x60	74	10,0	11,7	13,4	15,0	18,4	21,7
220x160x2.0	2 x 40	180	4x40	54	10,4	12,1	13,8	15,5	19,0	22,4
			4x50	64	12,2	14,3	16,3	18,3	22,4	26,5
			4x60	74	13,0	15,2	17,4	19,6	23,9	28,3
220x180x2.0	2 x 46	200	4x40	54	13,1	15,3	17,4	19,6	24,0	28,3
			4x50	64	15,4	18,0	20,6	23,1	28,3	33,4
			4x60	74	16,5	19,2	22,0	24,7	30,2	35,7
220x200x2.0	2 x 52	220	4x40	54	16,1	18,8	21,5	24,2	29,5	34,9
			4x50	64	19,0	22,2	25,3	28,5	34,8	41,1
			4x60	74	20,3	23,7	27,0	30,4	37,2	43,9
220x220x2.0	2 x 58	240	4x40	54	19,4	22,6	25,9	29,1	35,6	42,0
			4x50	64	22,9	26,7	30,5	34,3	41,9	49,6
			4x60	74	24,4	28,5	32,6	36,6	44,8	52,9
220x240x2.0	2 x 64	260	4x40	54	23,0	26,8	30,6	34,4	42,1	49,7
			4x50	64	27,1	31,6	36,1	40,6	49,6	58,7
			4x60	74	28,9	33,7	38,5	43,4	53,0	62,6
220x260x2.0	2 x 70	280	4x40	54	26,8	31,2	35,7	40,1	49,0	58,0
			4x50	64	31,6	36,8	42,1	47,3	57,8	68,4
			4x60	74	33,7	39,3	44,9	50,5	61,8	73,0
220x280x2.0	2 x 76	300	4x40	54	30,8	35,9	41,0	46,2	56,4	66,7
			4x50	64	36,3	42,3	48,4	54,4	66,5	78,6
			4x60	74	38,7	45,2	51,7	58,1	71,0	83,9
220x300x2.0	2 x 82	320	4x40	54	35,0	40,8	46,6	52,5	64,1	75,8
			4x50	64	41,3	48,1	55,0	61,9	75,6	89,4
			4x60	74	44,1	51,4	58,7	66,1	80,8	95,5
220x320x2.0	2 x 88	340	4x40	54	39,4	45,9	52,5	59,1	72,2	85,3
			4x50	64	46,4	54,2	61,9	69,7	85,1	101
			4x60	74	49,6	57,9	66,1	74,4	90,9	107
220x340x2.0	2 x 94	360	4x40	54	43,9	51,3	58,6	65,9	80,6	95,2
			4x50	64	51,8	60,5	69,1	77,7	95,0	112
			4x60	74	55,3	64,6	73,8	83,0	101	120
220x360x2.0	2 x 100	380	4x40	54	48,6	56,8	64,9	73,0	89,2	105
			4x50	64	57,4	66,9	76,5	86,1	105	124
			4x60	74	61,3	71,5	81,7	91,9	112	133
220x380x2.0	2 x 106	400	4x40	54	53,5	62,4	71,3	80,2	98,0	116
			4x50	64	63,1	73,6	84,1	94,6	116	137
			4x60	74	67,3	78,6	89,8	101	123	146